

1,833 SF OFFICE SPACE FOR LEASE

41990 Cook St. Building I #802, Palm Desert



FEATURES

- Excellent location at the corner of Hovely Lane & Cook st.
- Mid Valley location with easy access to all Desert Cities
- Possible uses include: general office, medical office, or medical laboratory.
- Premier well maintained office park
- Excellent signage on two sides of building
- Covered parking

Price: \$2,107.95/MO (\$1.15/SF) NNN

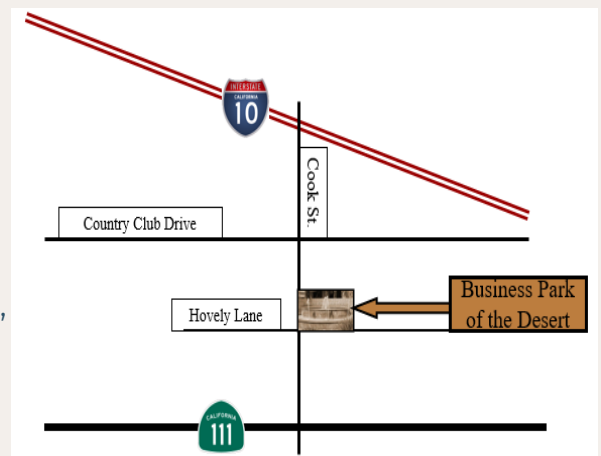

VICINITY MAP

Paula Turner
paula@dppllc.com
760-578-6564 Mobile
CA DRE #00702492

Susan Harvey
susan@dppllc.com
760-250-8992 Mobile
CA DRE #00957590

1,833 SF OFFICE SPACE

BUSINESS PARK OF THE DESERT



SITE AMENITIES

- Address: 41990 Cook St. Building I #802, Palm Desert
- RBA: Approx. 1,833 SF
- Zoning: O-P (Office Professional)
- General Plan: C-OP (Office Professional)
- Year Built: 2006
- Parking Spaces: 11 (6/1000)

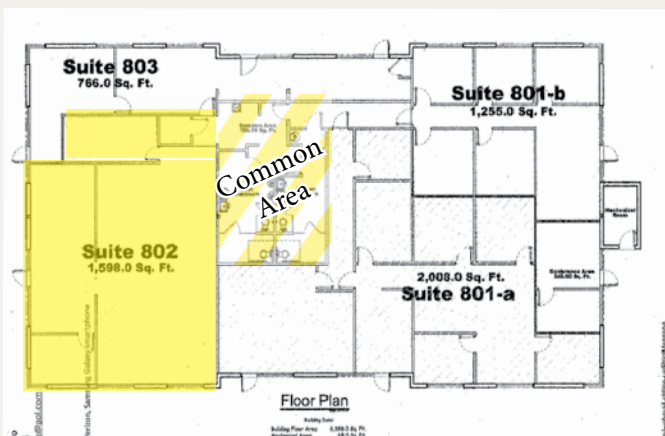

FLOOR PLAN